

Fuse link SEV G6 500V (gG)



See below:

[Approvals and Compliances](#)

Description

- According to IEC 269
- According to EN 60269
- Selectivity 1:1.6
- Removal tags energized
- Dimensions according to SNV 24482

Unique Selling Proposition

- Characteristic gG
- Full-range fuse-links for general applications

Weblinks

[pdf data sheet](#), [html datasheet](#), [Detailed request for product](#)

Technical Data

| | |
|---------------------------------|------------|
| Rated Current In | 160- 630 A |
| Rated Voltage | 500 VAC |
| Breaking Capacity | 120 kA |
| Rated Power Operating Frequency | 50 Hz |

Basic Design

| | |
|------------------|---------------------------------|
| Insulator | Ceramics |
| Metal components | corrosion-resistant (rustproof) |

Power Dissipation (Watt) operating temperature max.

The power dissipation is the so called power loss at rated current load and operation temperature acc. VDE 0636 . It is to be measured in Watt at AC condition. The voltage tap is to be assured that the power dissipation of the blade contacts are included. This means the measure contact need to be applied at the ends of the blade contacts. The standard VDE 0636 part 1 and 2 requires that following maximal permissible power losses are not exceeded.

Approvals and Compliances

Detailed information on product approvals, code requirements, usage instructions and detailed test conditions can be looked up in [Details about Approvals](#)

Compliances

The product complies with following Guide Lines

| Identification | Details | Initiator | Description |
|----------------|---------|-------------|---|
| REACH | REACH | SCHURTER AG | On 1 June 2007, Regulation (EC) No 1907/2006 on the Registration, Evaluation, Authorization and Restriction of Chemicals 1 (abbreviated as "REACH") entered into force. |

Dimensions [mm]

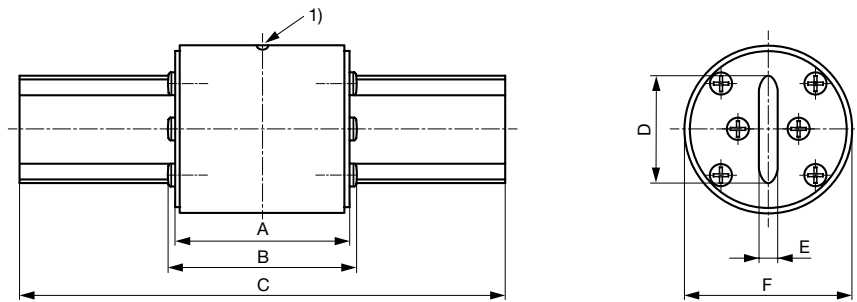

| SEV | A | B | C | D | E | F |
|-----|----|----|-----|----|---|----|
| 2 | 53 | 58 | 134 | 25 | 5 | 45 |
| 4 | 61 | 65 | 162 | 35 | 6 | 55 |
| 6 | 66 | 70 | 188 | 42 | 8 | 70 |

1) Indicator

Time-Current-Curves

SEV G2 - G6

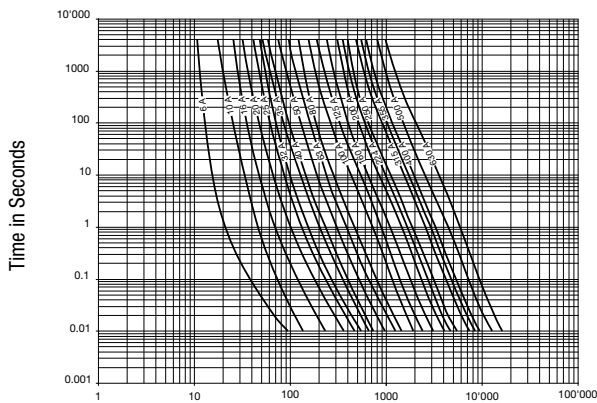

Current in Amperes

All Variants

| Rated current [A] | Style [Compact] | Power Loss [W] | Order Number | E-No. |
|----------------------|--------------------|-------------------|--------------|-----------|
| 160 | - | - | 0001.4325 | 840112239 |
| 200 | - | - | 1301.2221 | 840112249 |
| 250 | - | - | 1301.2222 | 840112269 |
| 315 | - | - | 1301.2223 | 840112289 |
| 355 | - | - | 0001.4326 | - |
| 400 | - | - | 1301.2224 | 840112309 |

| Rated current [A] | Style [Compact] | Power Loss [W] | Order Number | E-No. |
|----------------------|--------------------|-------------------|--------------|-----------|
| 500 | - | - | 1301.2225 | 840112319 |
| 630 | - | - | 1301.2226 | 840112329 |

Most Popular.

Availability for all products can be searched real-time:<https://www.schurter.com/en/Stock-Check/Stock-Check-SCHURTER>

| | |
|-----------------------|-------|
| Packaging unit | 3 Pcs |
|-----------------------|-------|